

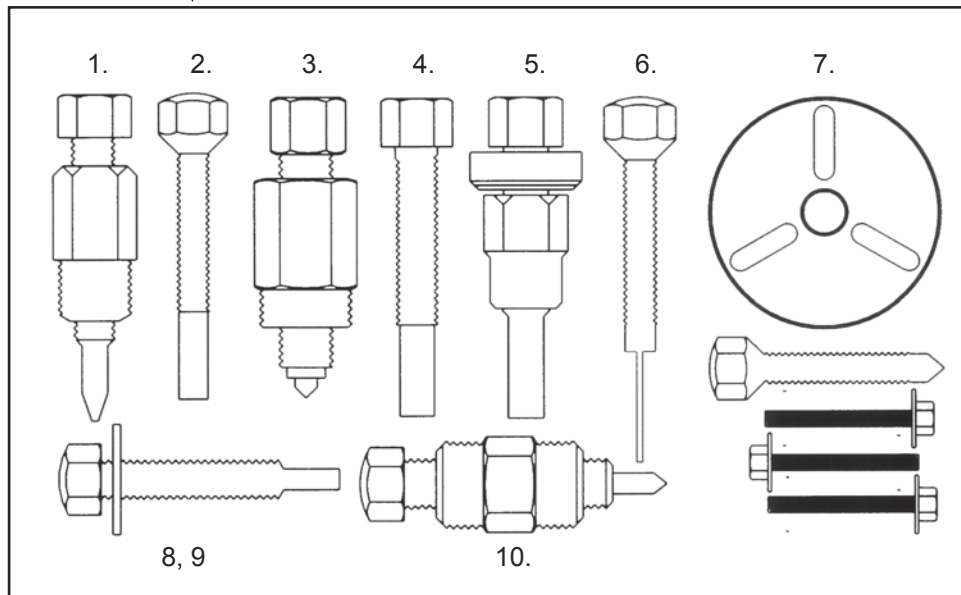

Mastercool[®]
"World Class Quality"

**DELUXE A/C CLUTCH HUB
PULLER & INSTALLER**

**REPAIRABLE PARTS BREAKDOWN
(91000-A)**



REF. #	DESCRIPTION	PART #
1.	GM CLUTCH PLATE REMOVER	90454
2.	GM CLUTCH PLATE REMOVER ARBOR	91195
3.	GM DA-6 CLUTCH PLATE REMOVER	91212
4.	CLUTCH END PLATE ARBOR	91260
5.	GM CLUTCH PLATE INSTALLER	90458
6.	DIESEL KIKI/MITSUBISHI DEEP REMOVER ARBOR	92260
7.	SANKYO CLUTCH PLATE PULLER WITH 3 BOLTS AND WASHER	90902
8.	5/8" SAE FLATWASHER ZP	0281-054
9.	ARBOR	1052-001
10.	CLUTCH PLATE REMOVER	91122

1052-001

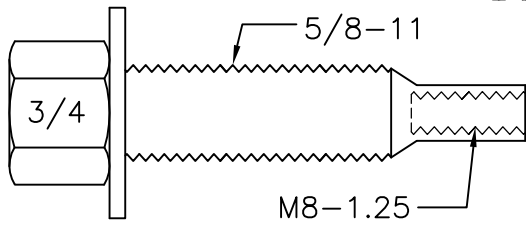

90454

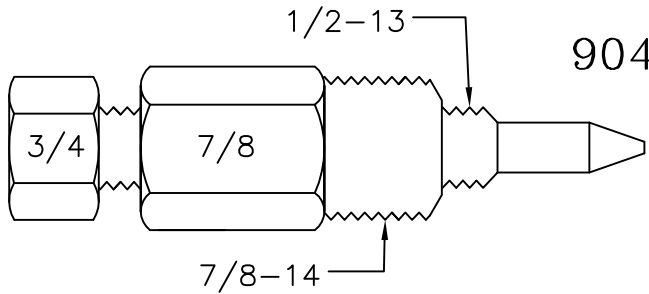

90458

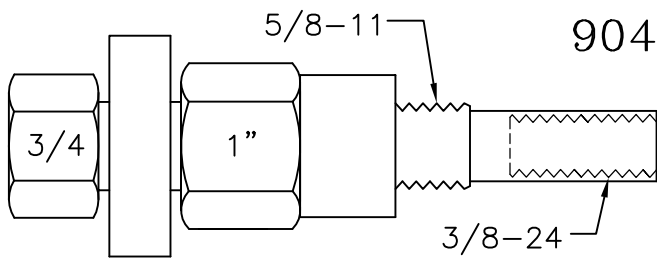

90902

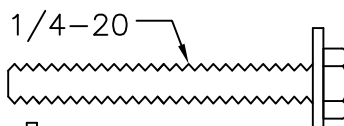
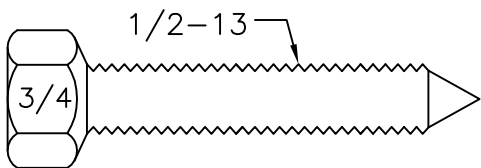
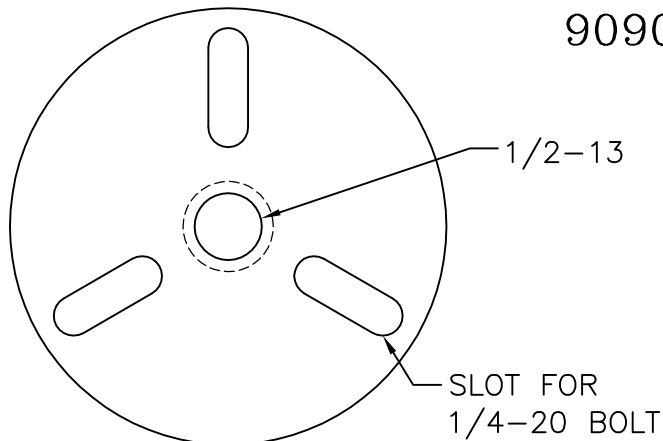

10mm

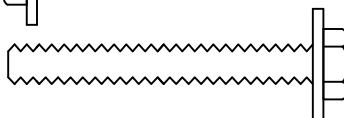
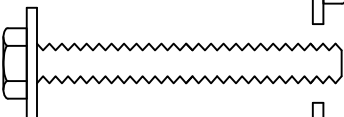

91122

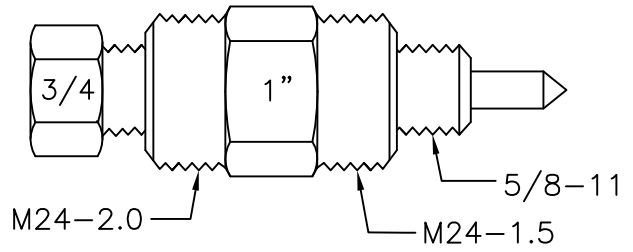

91195

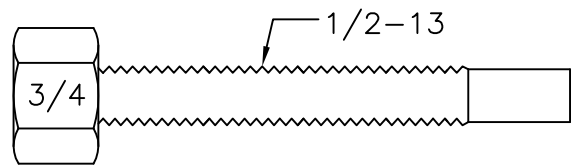

91212

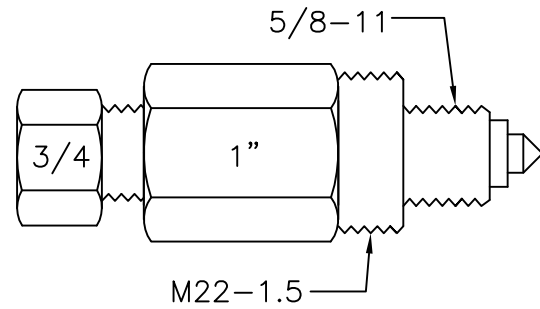

91213

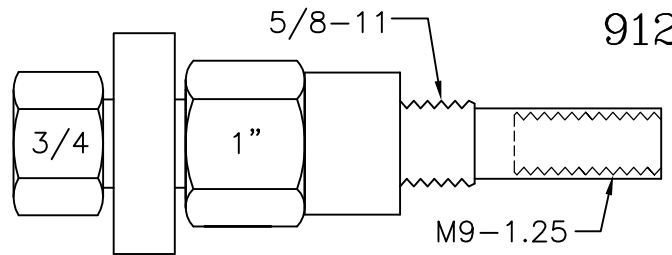

91260

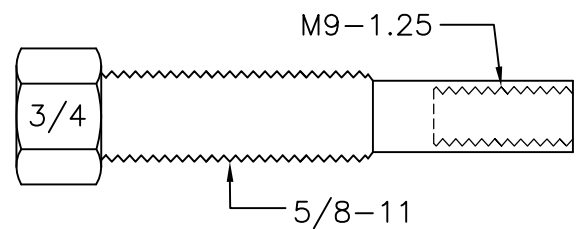

92260

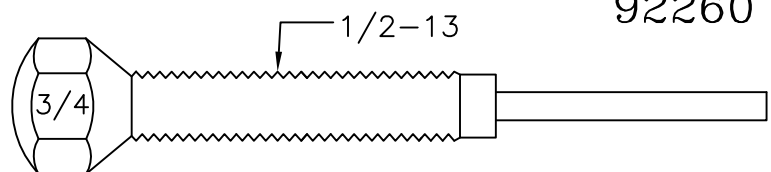

91000-A DLX CLUTCH HUB PULL-INSTALL KIT